

DCLNR/L

Applicable inserts
CN □□

Negative rake
"One-Double" system

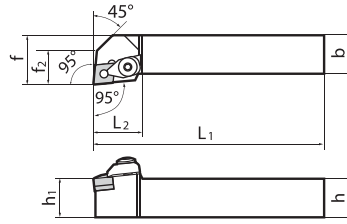
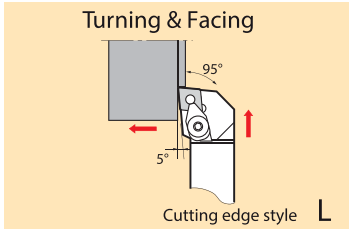

Right hand (R) shown.

4

TAC External Toolholders

Toolholders Cat. No.	Stock		Dimensions (mm)							Std. Corner r _ε	Applicable inserts	Page
	R	L	h	b	L ₁	L ₂	h ₁	ff	2			
DCLNR/L2020K12	●	●	20	20	125	30	20	25	18	0.8	CN □□1204 □□ (Except for 57-type chipbreaker inserts)	2-42 ~ 3-7 ~ T-CBN 3-21 ~ T-DIA
DCLNR/L2525M12	●	●	25	25	150	30	25	32	18			
DCLNR/L3225P12	●	●	32	25	170	30	32	32	18			
DCLNR/L3225P16			32	25	170	40	32	32	22	1.2	CN □□1606 □□ (Except for 57-type chipbreaker inserts)	2-45 ~
DCLNR/L3232P16			32	32	170	40	32	40	22			
DCLNR/L3232P19			32	32	170	45.5	32	40	25	1.2	CN □□1906 □□ (Except for 57-type chipbreaker inserts)	2-45 ~
DCLNR/L4040R19			40	40	200	45.5	40	50	25			